

ECO STOVE™

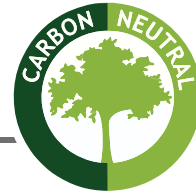

wraps your house in warmth



The Simple Biomass Heating Solution

INNOVATION IN SILICON CARBIDE

MORE THAN JUST A STOVE

What is Silicon Carbide

Silicon Carbide (SiC) is a product of Carbon and Silica fused to produce a very hardwearing refractory material capable of withstanding high combustion temperatures for a perfect burn and extremely low emissions. SiC has the characteristic of inducing high combustion temperatures and when blended with other minerals retain heat for a long period of time.

Silicon Carbide is the next hardest wearing material to diamond.



SILICON CARBIDE

Heat much more of the home than just a room

The Ecco Stove® operation is quite the opposite to that of a conventional steel or cast iron stove.



Rather than reducing the airflow to the stove and burning inefficiently trying to keep the fire going as long as possible, the Ecco Stove® can be fired with the correct ratio of combustion air to charge the silicon carbide with heat. Once the fire has gone out the Ecco Stove® can then distribute the heat through the home for up to 12 hours.

There is no need to supervise the stove and manage the air controls and load or even be present once the stove has been fired. The silicon carbide body of the appliance will radiate the heat stored at lower frequency heat waves, building up a natural convection through the home circulating and warming the air in each room. This also means that you are not walking from a hot room to a cold room but achieve balanced heat throughout.

You can of course fire the Ecco Stove® as often as you like should you want to see an attractive flame burning but this is not a necessary requirement once the stove has been charged with heat.

The Ecco Stove® has all the technology embodied within modern conventional stoves on the market (primary, secondary & tertiary air input) with the added benefit of extracting waste heat from the flue gases by passing them through 4-6 metres of fine channels to capture any heat wasted adding to the heat retention capabilities of the stove. This can be illustrated by the difference in the temperature between the fire chamber and flue gases, the fire chamber will typically burning at 900-1000°C although only sending 160-180°C as lost heat to the flue.

E580

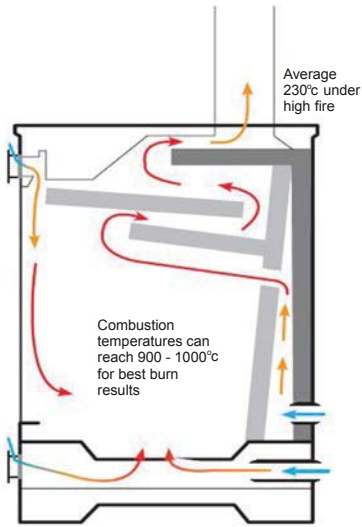

SPECIFICATIONS

Heating Capacity	Up to 140m ² (1500ft ²)
Rooms Heated	Up to 6
Fuel types	Wood logs or smokeless fuel
Tested on	Wood logs
Standard tested to	EN13240
Defra	Exempt
Height	730mm (28 ³ / ₄ "
Width	580mm (22 ³ / ₄ "
Depth	500mm (19 ³ / ₄ "
Weight	270kgs (595lbs)
Flue outlet dia	150mm (6")
Flue centre from rear	136mm (5 1/3")
Output at En13240	6.6kw / 21500 BTU
Log length	370mm (14 ¹ / ₂ "

Being one of the smallest masonry heaters available, the Ecco Stove® E580 will heat the home without over heating the initial room. The compact design is in keeping with the more traditional wood burning stove but with the benefit of spreading heat over a larger area, storing the heat for longer and a highly efficient combustion system.

Masonry heaters are traditionally heavier than normal wood burning stoves due to the considerable advantages of thermal mass.

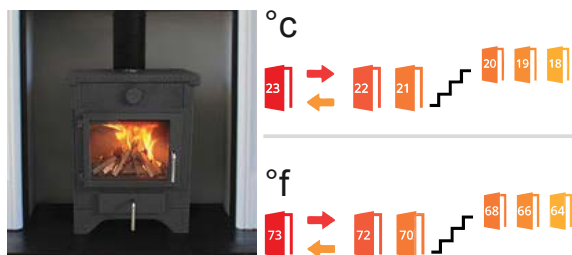

KEY



E678



SPECIFICATIONS

Heating Capacity	Up to 240m ² (2300ft ²)
Rooms Heated	Up to 10
Fuel types	Wood logs or smokeless fuel
Tested on	Wood logs
Standard tested to	EN13240 EN15250 Washington Colorado EPA parallel - Safety tested
Defra	Exempt
Height	878mm (34½")
Width	678mm (26¾")
Depth	525mm (20¾")
Weight	550kgs (1212lbs)
Flue outlet dia	150mm (6")
Flue centre from rear	136mm (5 5/14")
Output at En13240	9.4kw (32,000 BTU)
Thermal output	114mj
Stored heat	25% AT 12.3 hrs
Log length	370mm (14½")

The most popular model in the Ecco Stove® masonry heater range with an optimal balanced of heat retention and heat distribution making it the flagship of the models available. Its unique style with curved front makes it suitable for both traditional and contemporary rooms.

The E678 is one of the only products on the market to have passed both EN13240 and EN15250 certification from Europe.

Masonry heaters are traditionally heavier than normal wood burning stoves due to the considerable advantages of thermal mass.

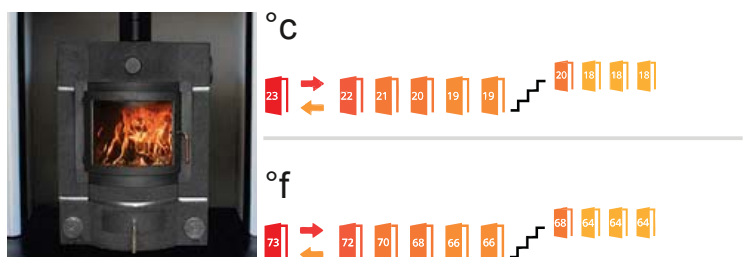

KEY





E730



SPECIFICATIONS

Heating Capacity	Up to 260m ² (2500ft ²)
Rooms Heated	Up to 12
Fuel types	Wood logs or smokeless fuel
Tested on	Wood logs
Standard tested to	EN13240 EN15250
Defra	Exempt
Height	1046mm (41¼")
Width	730mm (28¾")
Depth	500mm (19¾")
Weight	600kgs (1322lbs)
Flue outlet dia	150mm (6")
Flue centre from rear	143mm (5 10/17")
Output at En13240	10.5kw (34,000 BTU)
Thermal output	120.7mj
Stored heat	25% at 7 hours
Log length	400mm (15¾")

The most modern design in the unique Ecco Stove® range with high heat retention and heat distribution properties. The modern oval design makes the E730 a perfect compliment to a modern style living space with a tall glass for optimum view of the fire. You can see a good example of how the E730 can heat a large farm house in one of our case studies.

The E730 is one of the only products on the market to have passed both EN13240 and EN15250 certification from Europe. Masonry heaters are traditionally heavier than normal wood burning stoves due to the considerable advantages of thermal mass.

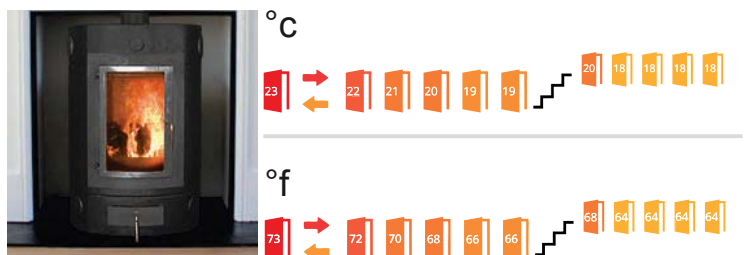

KEY

23 Room containing stove & temperature
 22 Downstairs room & temperature
 21 Upstairs room & temperature

Stairs
 Heat Flow

E850



SPECIFICATIONS

Heating Capacity	Up to 280m ² (3000ft ²)
Rooms Heated	Up to 15
Fuel types	Wood logs or smokeless fuel
Tested on	Wood logs
Standard tested to	EN13240 EN15250 Washington Colorado EPA parallel - Safety tested
Defra	Exempt
Height	1120mm (44")
Width	850mm (33½")
Depth	540mm (21¼")
Weight	800kgs (1752lbs)
Flue outlet dia	150mm (6")
Flue centre from rear	115mm (4½")
Output at En13240	11.5kw (38,000 BTU)
Thermal output	134mj
Stored heat	25% AT 7 hrs
Log length	483mm (19")

The largest model in the Ecco Stove range with high heat retention and heat distribution properties. The curved front design makes it suitable for the more modern or traditional living space.

The E850 is one of the only products on the market to have passed both EN13240 and EN15250 certification from Europe.

Masonry heaters are traditionally heavier than normal wood burning stoves due to the considerable advantages of thermal mass.

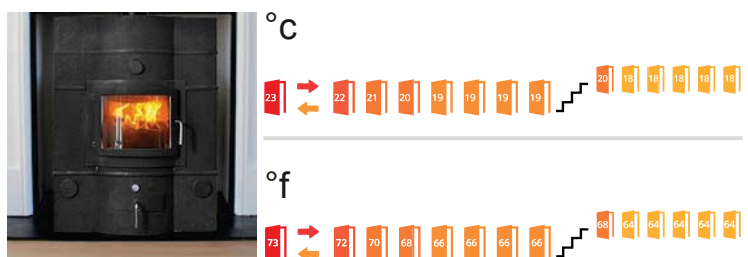

KEY



STOVE TECHNOLOGY

A) Air is drawn into the ash pit (primary air) to rapidly heat the mass up to minimum 150°C being 302°F top centre (ideally 200°C BEING 392°F) when catalysing begins within the firebox.

B) Flue gas is deflected by a baffle system toward A and B simultaneously for clean glass operation and turbulence within the combustion process.

C) Gasification takes place via tertiary air introduction for cleanest combustion after which flue gas passes through the appliance via double pass contraflow flue ways to absorb as much heat from the flue gas before exiting to atmosphere

Contra flow flue gas channels
E678 & E850



PRIMARY AIR
Cold air in.

SECONDARY AIR
Pre-heated air for clean glass operation.

TERTIARY AIR
Pre-heated for final re-burn within fire chamber for clean exhaust gases

The multitude of flue ways within the Ecco Stove® extract almost all heat from the gas before exhaust to atmosphere.

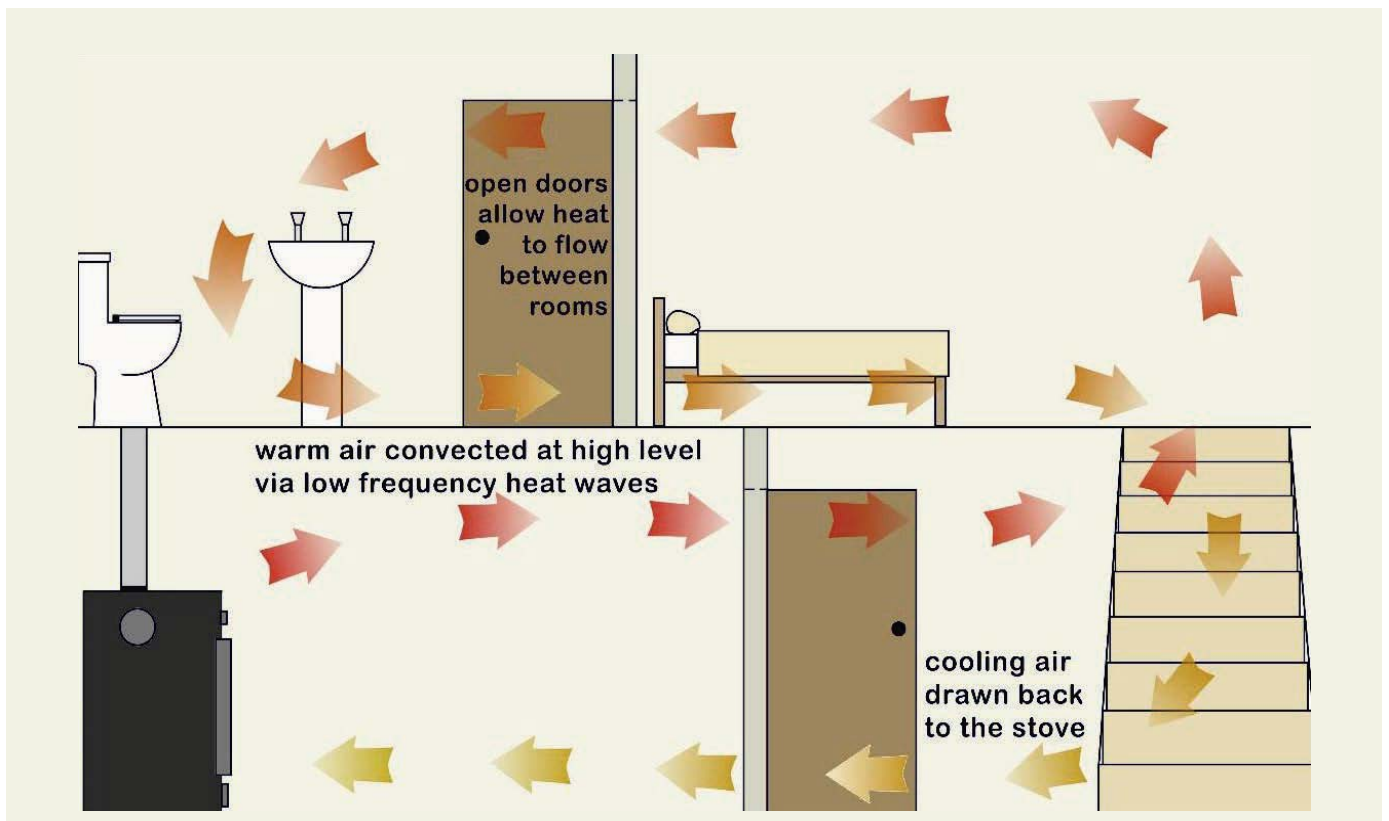

SPECIFICATIONS

Distances

Distances E580	Top	Sides	Rear	Front
Combustibles*	350mm / 13 3/4"	300mm / 11 3/4"	200mm / 7 7/8"	350mm / 13 3/4"
Non Combustible	125mm / 4 7/8"	125mm / 4 7/8"	75mm / 3"	300mm / 11 3/4"
Minimum Opening	Height		Width	
	855mm / 33 15/8"		830mm / 32 5/8"	

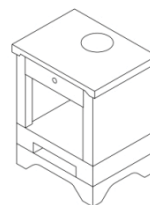

Height 730mm / 28 3/4"

Width 580mm / 22 3/8"

Depth 500mm / 19 3/4"

Distances E678	Top	Sides	Rear	Front
Combustibles*	350mm / 13 3/4"	430mm / 16 15/16"	280mm / 11"	400mm / 15 3/4"
Non Combustible	125mm / 4 7/8"	125mm / 4 7/8"	75mm / 3"	300mm / 11 3/4"
Minimum Opening	Height		Width	
	1000mm / 39 3/8"		928mm / 36 1/2"	

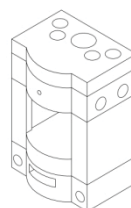

Height 878mm / 34 1/2"

Width 678mm / 26 3/4"

Depth 525mm / 20 3/4"

Distances E730	Top	Sides	Rear	Front
Combustibles*	350mm / 13 3/4"	500mm / 19 3/4"	400mm / 15 3/4"	400mm / 15 3/4"
Non Combustible	125mm / 4 7/8"	125mm / 4 7/8"	75mm / 3"	300mm / 11 3/4"
Minimum Opening	Height		Width	
	1171mm / 46 7/64"		980mm / 38 37/64"	

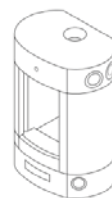

Height 1046mm / 41 1/4"

Width 730mm / 28 3/4"

Depth 500mm / 19 3/4"

Distances E850	Top	Sides	Rear	Front
Combustibles*	350mm / 13 3/4"	600mm / 23 5/8"	500mm / 19 3/4"	300mm / 11 3/4"
Non Combustible	150mm / 5 7/8"	125mm / 4 7/8"	75mm / 3"	300mm / 11 3/4"
Minimum Opening	Height		Width	
	1270mm / 50"		1100mm / 43 1/4"	

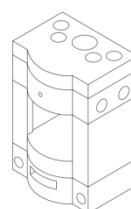

Height 1120mm / 44"

Width 850mm / 33 1/2"

Depth 540mm / 21 1/4"

OPTIONS

E580 – colour choices available, stove body and trims can be different.

E678 - colour choices available, stove body and trims can be different. E678 top is a full temperature graded hot plate. Domestic hot water coil can be added to the hotbox for domestic hot water production. Hotbox can be used to duct warm air to other rooms by convection (increasing the height of the stove by 100mm being 4") E678 comes with trims and now without if preferred.

E730 - choices available, stove body and trims can be different. E730 top is a full temperature graded hot plate.

E850 - colour choices available, stove body and trims can be different. E580 has 4 usable hotplates on its top surface, the 2 front are boiling and two back are simmering, when the stove is up to full temperature.

COLOUR OPTIONS AVAILABLE

custom options available upon request



Light grey



Anthracite



Mojave red



Almond



Metallic blue

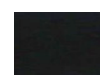

Flat black



Sparkle black



Honey glow



Natural

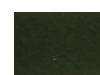

Forest Green

Please note colours are an example although may vary on finished appliance

MORE THAN JUST A BROCHURE

Heat Plan

If you have any plans for your property or capabilities to draw some and send to Ecco Stove®, our staff can draw up a suggested heat plan of room temperatures through your home when using the Ecco Stove® model of your choice free of charge with suggested annual fuel usage.

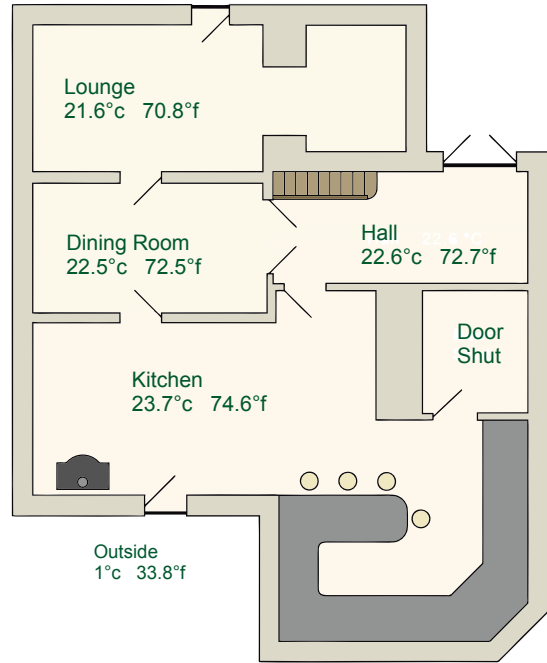
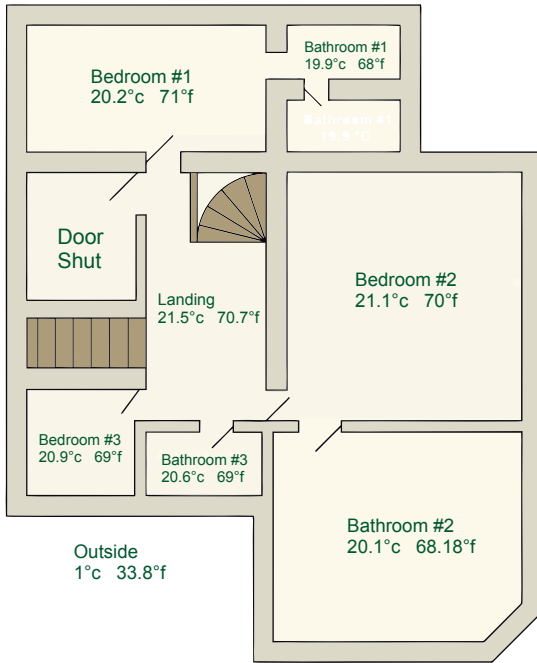

Website

We have a range of information and tools available on our website www.eccostove.com such as customise your stove allowing you to design your own Ecco Stove® and print or download a specification sheet.

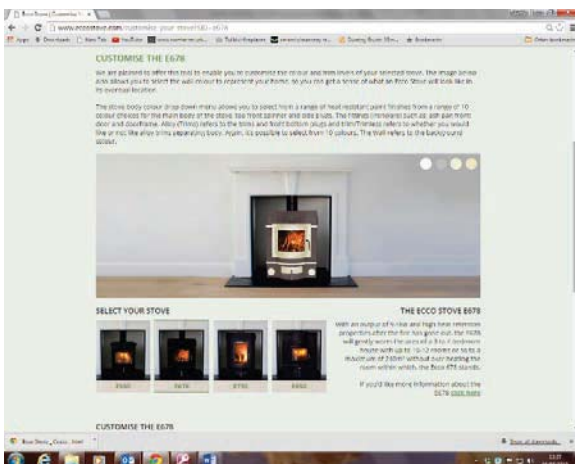

ECO STOVE™

wraps your house in warmth



ECO STOVE™

Landy Vent UK Ltd.
Foster House
2 Redditch Road
Studley
B80 7AX

Telephone: +44 (0) 1527 857 814
US & Canada: 0011 44 (0) 1527 857 814

Fax: +44 (0) 1527 854 140
US & Canada: 0011 44 (0) 1527 854 101



Email: info@eccostove.com

www.eccostove.com

Your local Ecco Stove® Specialist

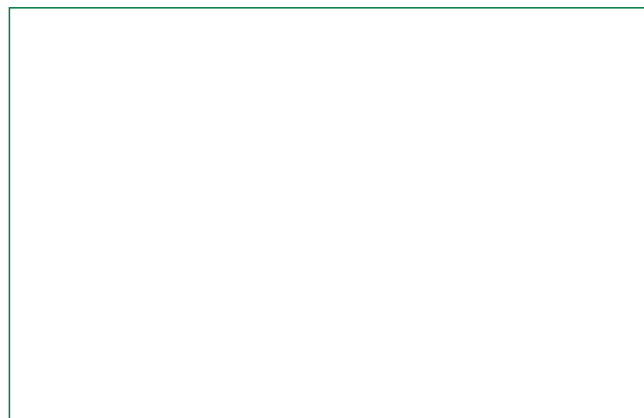

Specific technical information should be sought direct from the Ecco Specialist in your area.

We reserve the right to change dimensions and specifications in our products without notice. Contact us for new developments